

TWO SPEED HAND-HELD DIAMOND CORE DRILL



DF-330



JDPower-model	DF-330
Power	1350W
Speed (variable)	1st gear 0 - 1100 rpm 2nd gear 0 - 2200 rpm
Drilling range(hand-held)	20-76 mm (1"-3")
Drilling range(drill-rig)	20-120 mm (1"-5")
Machine weight	4.5 kg
*Toolbox included	
5/8" Male and 1 1/4" Male	

- **Options** - DRILL STAND, VACUUM PAD and PUMP
- **Toolbox Includes** - 27mm wrench, 36mm adjustable wrench, 1 1/4" adapter.

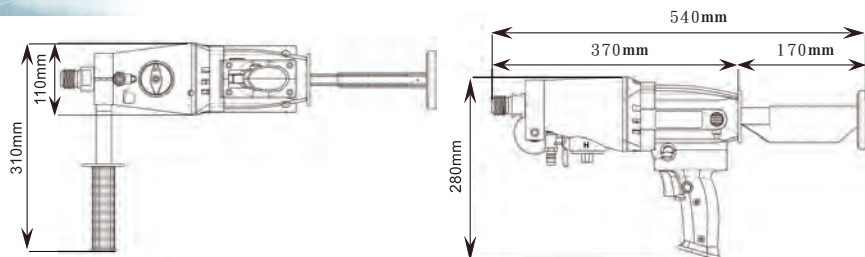

DR-120

Optional Drill Stand for DF-330 core drill



Model	DR-120
Effective stroke	520 mm
Capacity	20-120 mm (1"-5")
Dimensions	L360 x W176 x H760
Drill Press Lever	Insulated for safety
Water Collector	Included
Optional	VP Vacuum Pad and pump
Weight	9 kg

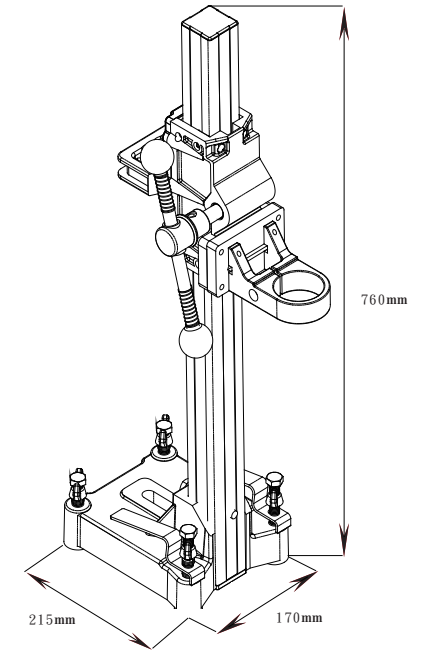

1. Patented **telescopic support arm** - makes drilling safer and more comfortable "lean into" or "rest on" the arm using your body weight, not your back!
2. **Powerful 1350W** motor.
3. **Safety Features** - protect Operator against cut electrical cables:
 - Double insulation on motor
 - Insulated handle
 - Insulated telescopic arm
 - Earth Leakage trip switch
4. **Motor overload protector** - protects motor and gearbox extending the life of the drill.
5. **Adjustable Slip-Clutch** - Protects motor, gearbox and Operator if core bits jam. Clutch is easily adjustable to extend the life of the core drill.
6. **Variable speed trigger** - for greater operator control.
7. **Soft start** - extends the life of the gearbox and motor.
8. **Two-Speed gear box**, low speed range of 1100rpm, and high speed range of 2200rpm.
9. Comes with **case** and **tools**