

VACUUM PUMP AND BASE PUMP - VP-26

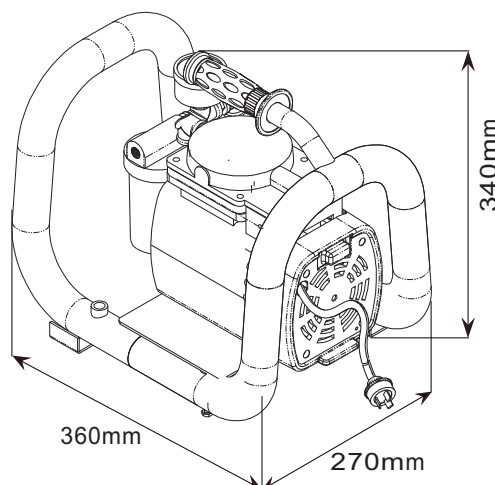

- ◆ Save Time
- ◆ Save Effort
- ◆ Neater Work

| Vacuum Pump | |
|----------------|--------------|
| Model | VP-26 |
| Current | 1.3 A |
| Load Speed | 1773 pm |
| Flow Rate | 45(L) / min |
| Vacuum | 26.5 in / Hg |
| Restart Vacuum | 25 in / Hg |
| Dimensions | 34x17x25 cm |
| Weight | 8 kg |



BASE - VPAS-6-01

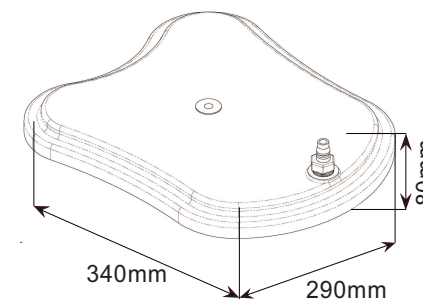
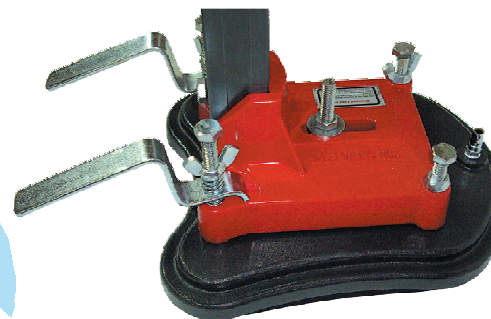

| Vacuum Base | |
|---------------------|-----------------|
| Model | VPAS-6-01 |
| Dimensions | 34x29x8 cm |
| Core Drill Capacity | 25-150mm(1"-6") |

| Compatible with the following Stands | |
|--------------------------------------|--------|
| • | DR-120 |
| • | KF-500 |
| • | DF-650 |
| • | DF-850 |

1. **Oilless pump**
2. Works on a **range of Surfaces**.
3. **Saves Time** - No mounting bolt for drill stand required.
4. **No extra clean-up** after the job (no mounting bolt to hide, cut or fill).
5. **Pump frame acts as water trap** to protect the pump
6. **Fast action** - around 20s to seal vacuum on a range of surfaces
7. Vacuum base can be **mounted on walls and floor**
8. **Easy to read** Vacuum Gauge.
9. **High restart vacuum** - If the pump momentarily loses power the VP-26 has a high restart vacuum extending the life of the pump and reducing wait time to restart drilling.